



Site Map

Community located in Crown Hill
on 13th Ave NW

Visit vwpre.com to get updated pricing or contact the account manager below

VWP

REAL ESTATE

WINDERMERE  REAL ESTATE

9013 - 9015

13th Ave NW, Seattle 98122

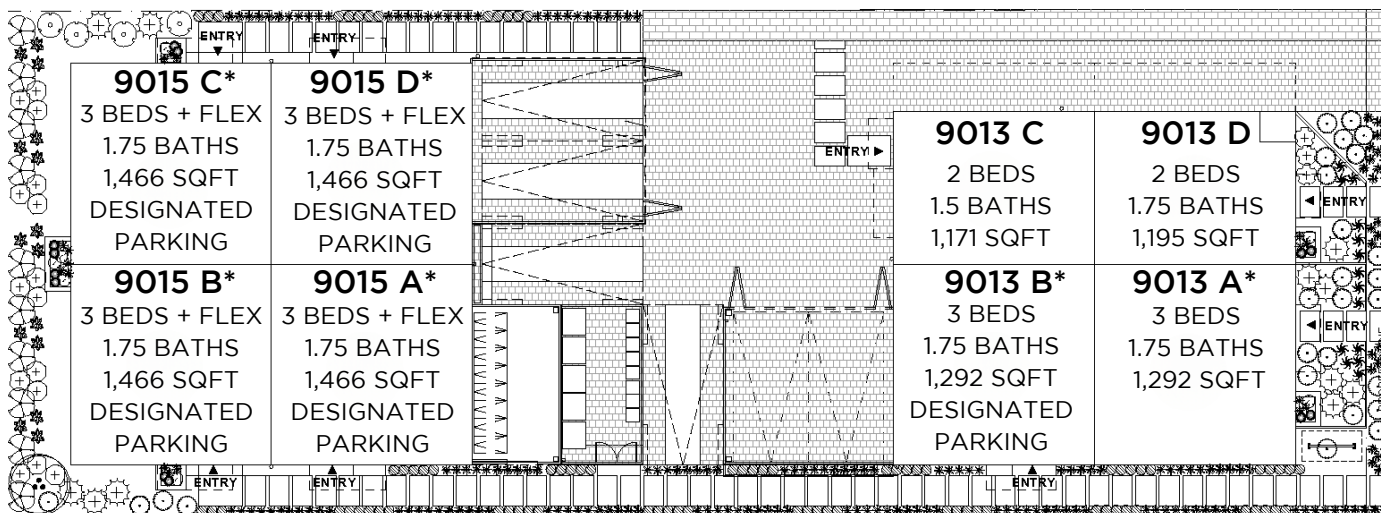

*DESIGNATED PARKING
+ EV READY

Community Specs:

2 - 3 Beds + Flex

1.5 - 1.75 Baths

1,171 - 1,466 Sq. Ft.

Designated Parking

+ EV Ready



Contact Diana Rayo with VWP Real Estate for more info:

Diana Rayo: 206-240-9128 | diana.rayo@windermere.com

Floor plans are provided for illustrative and general informational purposes only. Buyer to verify all information to their own satisfaction.

N←

WRE - Cap Hill | VWP Real Estate