



Site Map

Community located in West Seattle
on SW Mills St

Visit vwpre.com to get updated pricing or contact the account manager below

VWP

REAL ESTATE

WINDERMERE  REAL ESTATE

4326 A-C

SW Mills St, Seattle 98136

Community Specs:

3 Beds

2.5 - 3 Baths

1,597 - 1,803 Sq. Ft.

Designated - Garage Parking*

*For select homes

Built by:



ALLUVION
— HOMES —

WRE - Cap Hill | VWP Real Estate

SW MILLS ST

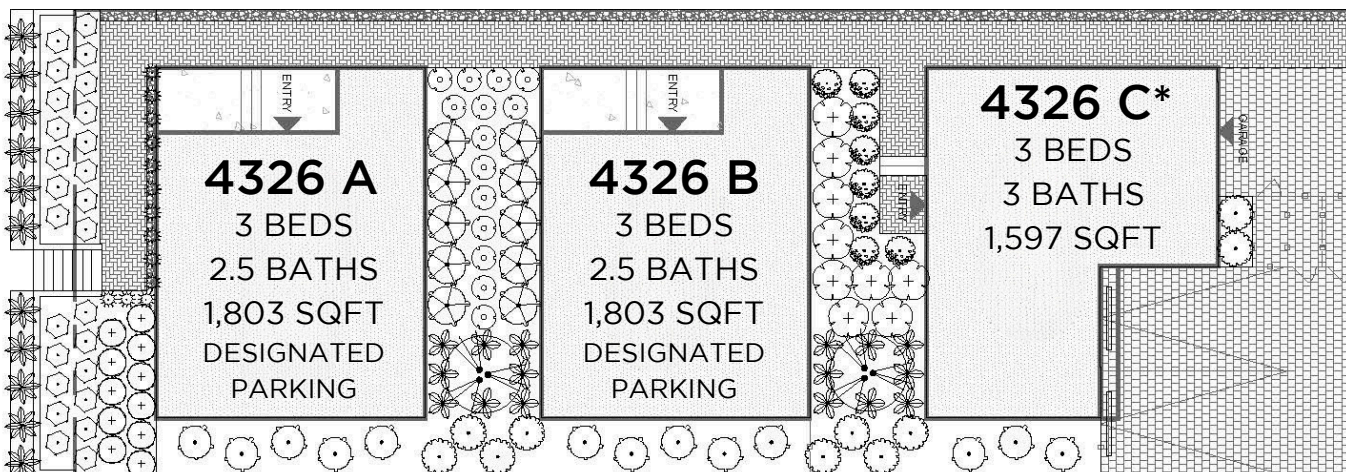

GARAGE PARKING

Contact Erin Porter with VWP Real Estate for more info:

Erin Porter: 206-582-8936 | erinporter@windermere.com

Floor plans are provided for illustrative and general informational purposes only. Buyer to verify all information to their own satisfaction.

N↑